

1020 HOBSON

DATE: 1/3/08  
INSTALLED BY: LARRY IRVING  
INSPECTED BY: MARTY CROSSLAND

STAEDTLER® No. 937 811E  
Engineer's Computation Pad



OAKWOOD AVE.

HOBSON STREET

R.R.

CB

GAS SHUTOFF

29'

23.5'

58'

52'

70'

PorCH

HN #1106

6" PVC  
SAN  
6' DEEP  
w/ PLUG

GARAGE

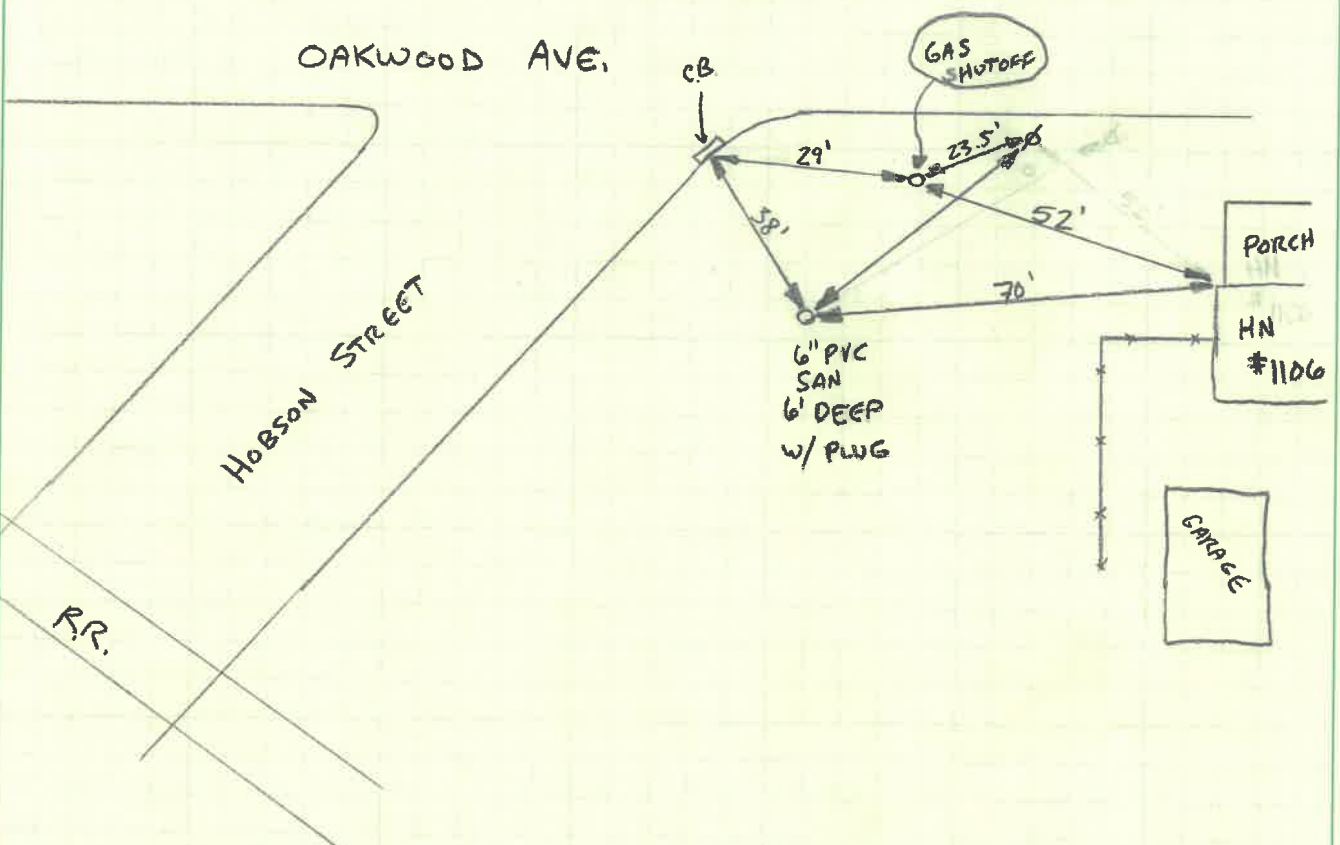

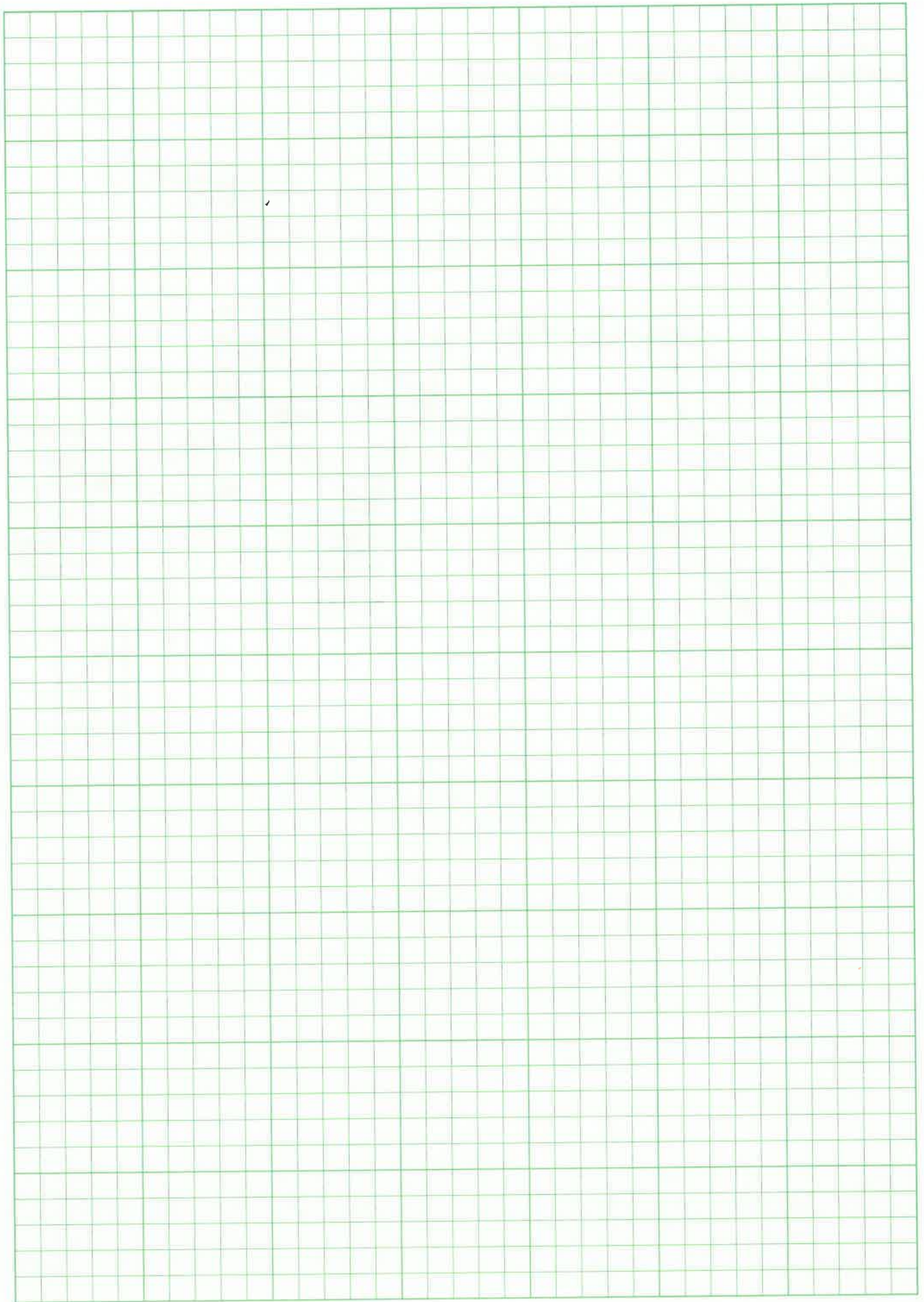

Dm2008-1#3000

# CITY OF NAPOLEON GENERAL PERMIT APPLICATION

THIS APPLICATION IS FOR RESIDENTAL CONSTRUCTION INCLUDING BUILDING, ELECTRICAL, PLUMBING, MECHANICAL, DEMOLITIONS, REMODELING.

DATE: \_\_\_\_\_ JOB LOCATION: Hobson - 1020

OWNER: DAVE BOGENT PHONE: 419-308-6948

OWNER ADDRESS: \_\_\_\_\_ CITY: \_\_\_\_\_ ZIP: \_\_\_\_\_

CONTRACTOR: L.J. IRVING JR

PHONE #: 419-592-8456 CELL PHONE# 419-467-6816

CONTRACTOR LICENSED WITH THE CITY OF NAPOLEON?: YES  NO:

Is any of the above job going to be subcontracted out? Yes  No:

If yes to whom: \_\_\_\_\_

DESCRIPTION OF WORK TO BE PERFORMED: DEMOL

ESTIMATED COMPLETION DATE: 7, 200

### PLEASE MARK THE TYPE OF WORK YOU WILL BE PERFORMING

- |  |   |
|--|---|
| <input type="checkbox"/> A/C ADD ON 1%                 | <input type="checkbox"/> REMODELING 1%            |
| <input type="checkbox"/> BOILER REPLACEMENT 1%         | <input type="checkbox"/> ROOFING 1%               |
| <input type="checkbox"/> CURBING                       | <input type="checkbox"/> SEWER REPAIRS**          |
| <input type="checkbox"/> DECKS * 1%                    | <input type="checkbox"/> SIDEWALK*                |
| <input type="checkbox"/> DRIVEWAY*                     | <input type="checkbox"/> SIDING 1%                |
| <input type="checkbox"/> ELECTRICAL SERVICE UPGRADE 1% | <input type="checkbox"/> SHED* (under 200 sq ft)  |
| <input type="checkbox"/> ELECTRICAL SERVICE NEW 1%     | <input type="checkbox"/> SHED* (over 200 sqft) 1% |
| <input type="checkbox"/> SWIMMING POOL* 1%             | <input type="checkbox"/> FENCE*                   |
| <input type="checkbox"/> FURNACE REPLACEMENT 1%        | <input type="checkbox"/> TEMP ELECTRIC 1%         |
| <input type="checkbox"/> ADDITIONS* 1%                 | <input type="checkbox"/> FURNACE NEW 1%           |
| <input type="checkbox"/> WATER TAP (size _____")       | <input type="checkbox"/> WINDOWS /DOORS 1%        |
| <input type="checkbox"/> LAWN METER 1%                 |   |
| <input type="checkbox"/> PLUMBING 1%                   |   |

### 1%- EFFECTIVE JUNE 1, 2007 BOARD OF BUILDING STANDARDS FEE

\*PLEASE INCLUDE A PICTURE SHOWING MEASUREMENTS FROM EXISTING STRUCTURES AND PROPERTY LINES. INDICATING THE TYPE OF WORK YOU WISH TO PERFORM.

\*\* IF WORK REQUIRES GOING INTO THE STREET A STREET BOND IS REQUIRED!

FOR PERMIT COSTS PLEASE FILL OUT REVERSE SIDE.



**PERMIT COST WORKSHEET**

<i><b>JOB</b></i>	<i><b>BASE FEE</b></i>	<i><b>1% BBS FEE =</b></i>	<i><b>PERMIT TOTAL</b></i>
SIDING (only) TOTAL SQ ____ X 1.00 = ____ +	\$5.00 +	1% =	
ROOFING (only) TOTAL SQ ____ X 1.00 = ____ +	\$5.00 +	1% =	
WINDOWS / DOORS(only) # ____ X 1.00 = ____ +	\$5.00 +	1% =	
ELECTRICAL # OF CIRCUITS ____ X 3.00 = ____ +	\$15.00 +	1% =	
ELECTRICAL SERVICE UPGRADE	\$15.00 +	1% =	
PLUMBING (INSIDE) replacing/ repairs	\$10.00 +	1% =	
SEWER (OUTSIDE)	\$25.00	N/A	
WATER HEATER	\$5.00 +	1% =	
SHED UNDER 200 SQ FT (over 200 see chart)	\$5.00	N/A	
FURNACE OR A/C (REPLACEMENT)	\$5.00 +	1% =	
DEMOLITION (only)	\$30.00	N/A	
SIDEWALK REPLACEMENT/ NEW	\$25.00	N/A	
DRIVEWAY	\$25.00	N/A	

ALL CONSTRUCTION, ALTERATIONS, REMODELING, SHEDS, DECKS, & FENCES NOT LISTED ABOVE IS BASED ON COST OF WORK BEING PERFORMED.

COST OF WORK \$ \_\_\_\_\_ (SEE CHART) permit fee \$ \_\_\_\_\_ + 1 % = \$ \_\_\_\_\_

0.00	-	250.00	0.00	11,000.00	-	11,999.00	25.00
250.00	-	999.00	10.00	12,000.00	-	12,999.00	26.00
1,000.00	-	1,999.00	12.00	13,000.00	-	13,999.00	27.00
2,000.00	-	2,999.00	14.00	14,000.00	-	14,999.00	28.00
3,000.00	-	3,999.00	16.00	15,000.00	-	15,999.00	29.00
4,000.00	-	4,999.00	18.00	16,000.00	-	16,999.00	30.00
5,000.00	-	5,999.00	19.00	17,000.00	-	17,999.00	31.00
6,000.00	-	6,999.00	20.00	18,000.00	-	18,999.00	32.00
7,000.00	-	7,999.00	21.00	19,000.00	-	19,999.00	33.00
8,000.00	-	8,999.00	22.00	20,000.00	-	20,999.00	34.00
9,000.00	-	9,999.00	23.00	21,000.00	-	21,999.00	35.00
10,000.00	-	10,999.00	24.00	22,000.00	-	22,999.00	36.00
				Over 22,999		Please Call	

\*OTHER FEES NOT LISTED MAY APPLY

***TOTAL PERMIT COSTS \$*** \_\_\_\_\_



43.5' in stone parking lot

76' of old walk that is capped over curb

Ex. sidewalk 4' wide right off back of curb

3

3

3



43.5' in stone parking lot

76' of old walk that is capped over curb

Ex. sidewalk 4' wide right off back of curb

